

Configure Menu Tabs

e-Builder lists each available module at the top of the page as a series of menu tabs. Chances are that you do not use all of these tabs. You can turn off tabs you do not use on a regular basis to reduce clutter.

To configure menu tabs:

- 1) In e-Builder, click on the + tab at the top of the page.

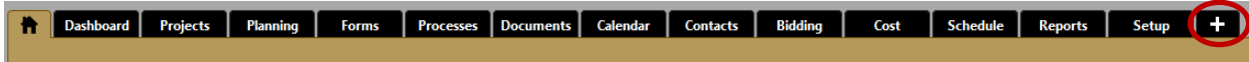

- 2) A pop-up menu will appear showing all of the available tabs. They are all checked by default. Uncheck any tab that you do not want displayed, then click the Save button.

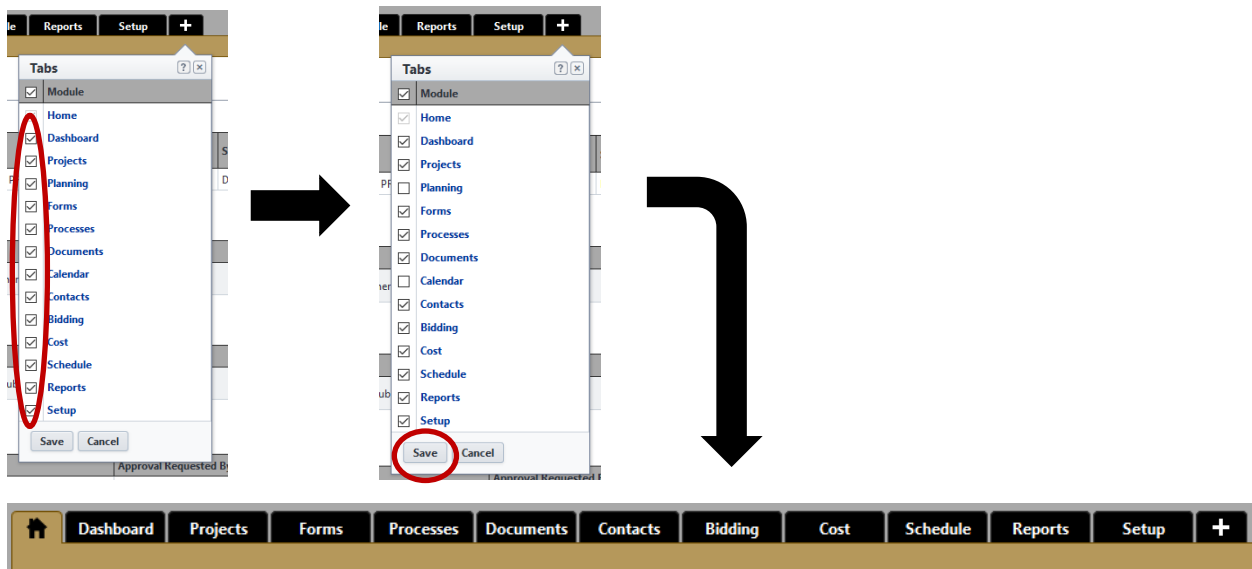

- 3) Turn the removed tabs back on by going back to the + menu and rechecking the empty boxes. Click Save.